



EQUIPTER®
RB 4000



RB4000 SERVICE MANUAL

DISCLAIMER

The information in this manual is provided to promote the safe use of, and assist the operator in achieving the best performance from Equipter products described herein, for their intended applications.

All rights reserved. No part of this publication may be reproduced, stored in a retrieval system, or transmitted in any form or by any means, electronic, mechanical, photocopying, recording, or otherwise, without prior written permission of New Heights, LLC.

Covered by Patent Number 6817677

Copyright 2020 by New Heights, LLC

EQUIPTER SERVICE KIT PART LIST

- (1) Air Filter
- (1) Spark Plug
- (1) Engine Oil
- (1) Long Neck Funnel for Engine Oil
- (1) Grease Tube
- (1) 12mm Wrench
- (1) Pair of Gloves

See Index A of this booklet or contact your local service provider to purchase a service kit for your RB4000. **Equipter part #: RB4000 - 6 Month Service Kit - A.**

TABLE OF CONTENTS

Recommended Service Schedule	1
Replacement Parts.....	1
Maintenance Precautions.....	1
Replace Air Filter.....	2
Replace Spark Plug.....	2
Replace Engine Oil.....	3
Replace Hydraulic Oil Filter.....	3
Inspect Trailer Brakes.....	3
Inspect Parking Brake.....	4
Inspect Breakaway System.....	4
Inspect Hydraulic Hoses.....	4
Tires.....	4
Lubricate Fittings.....	5-6
Slide Rails.....	5
Wheel Lock Pin.....	5
Wheel Lock Handle.....	6
Front Axle Hub.....	6
Axle Engagement System.....	6
Index A: Service Providers.....	7
Index B: Service Checklist.....	8
Index C: Service Schedule.....	9-10

For more than 15 years, our team has manufactured Equipter products using top-quality processes and components. To protect your investment and ensure a long service life, it's essential to perform regular maintenance.

If you encounter wear beyond what's outlined in this manual, see Index A to have your RB4000 serviced at a qualified shop.

Recommended Service Schedule

We recommend doing the first preventative maintenance at about 30 service hours. Following this service, select maintenance tasks should be performed monthly, every six months, and so forth. Please refer to Index B: Service Checklist for a comprehensive list of preventative maintenance tasks and when to complete them.

Replacement Parts

Use only manufacturer-recommended replacement parts. Other parts may be substandard in fit and quality.

For additional replacement parts, contact the service provider (Index A).

Maintenance Precautions

Always take proper safety precautions while servicing this equipment. For complete RB4000 safety and operation guidelines, refer to the Operator's Manual. If you do not have a manual, contact the manufacturer's recommended service provider.

Always perform maintenance when the vehicle is level.

Never do any maintenance or adjustments while the equipment is operating. Turn off the engine when performing maintenance to prevent accidental movement.

Never perform maintenance on this machine unless the dump box is completely in the transport position (fully retracted and lowered). To perform maintenance under the dump box, the box can be tilted in the dump position. It must be secured with the support arm in place. Never perform maintenance with the dump box in the lifted position. (See "Lubricate Fittings" on page 5 for instructions.)

Make sure all operating and residual pressures are relieved before working on a hydraulic system.

Shut engine off and operate all the controls to relieve any pressure. The lines from the counterbalance valves to the cylinders will remain under pressure. It is recommended that a bleed valve be used to relieve the pressure in these lines when performing maintenance. If a bleed valve is not part of the counterbalance block or hydraulic circuit, the only way to bleed the pressure from these lines is to crack the hydraulic hose connections.

Note: Adjusting hydraulic hose connections may cause injury.

Replace all safety shields and guards when finished performing maintenance. Do not operate the equipment with protective equipment removed.

REPLACE AIR FILTER

1. Unscrew the wing knob.
2. Remove the air filter cover.
3. Remove the wing nut.
4. Lift the old air filter away and replace with the new filter.
5. Replace the wing nut.
6. Replace the air filter cover.
7. Replace the wing knob.

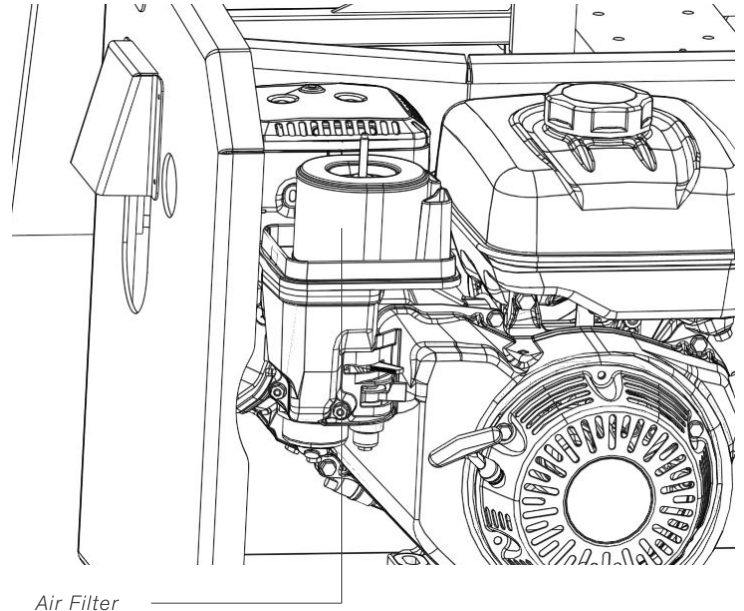

REPLACE SPARK PLUG

NOTE: The spark plug is easier to change with the air filter cover and base removed. The wrench can be found in the canister or holder that contains the RB4000 Operator's Manual.

1. Pull off the spark plug cap.
2. Use the wrench to unscrew the spark plug.
3. Install the spark plug carefully, by hand, to avoid cross-threading.
4. Tighten with the spark plug wrench to compress the sealing washer until it sets.
5. Tighten the new spark plug $\frac{1}{2}$ turn after the spark plug seats.
6. Push the cap back on.
7. Replace the air filter cover and base.

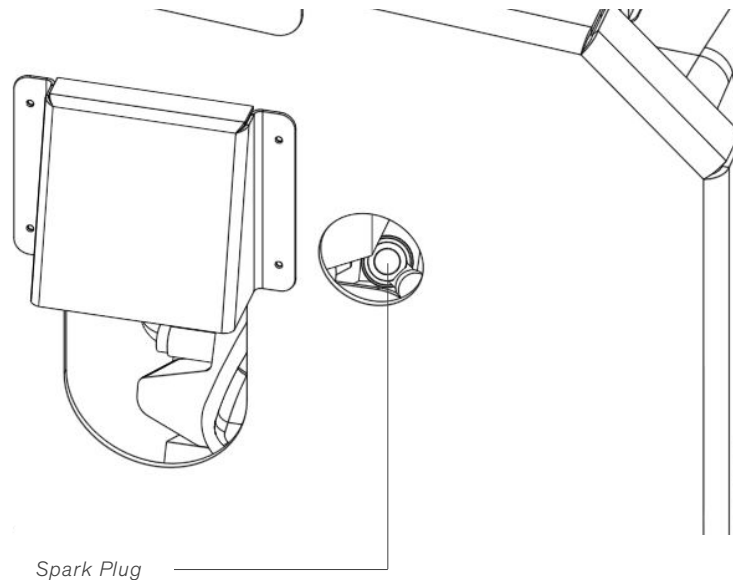

REPLACE ENGINE OIL

NOTE: Drain oil while the engine is still warm to ensure rapid, complete draining.

1. Undo the drain bolt using the 12mm wrench provided in this service kit.
2. Drain oil through the hole into an appropriate container.
3. Replace the bolt.
4. Remove the fill cap.
5. Insert the provided funnel through the fill hole.
6. Add new oil using 1 US quart of low-30 synthertic oil.
7. Replace the fill cap.

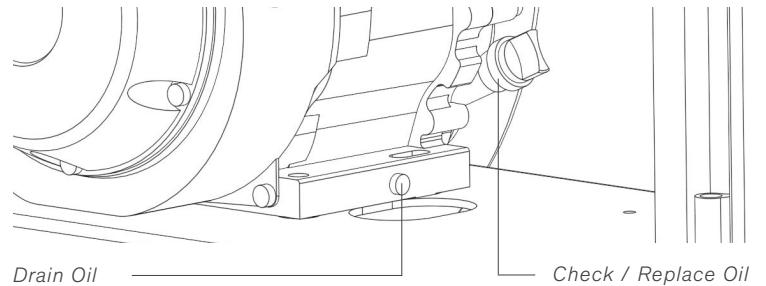
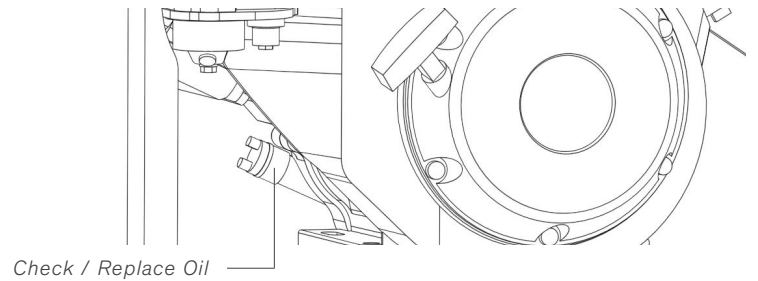

Always dispose of used oil in compliance with your local regulations.

REPLACE HYDRAULIC OIL FILTER

1. Unscrew the plastic cap of the hydraulic oil filter compartment.
2. Pull out the old oil filter and insert the new filter.
3. Add hydraulic oil until reading is full as indicated by the Fill Level decal on the hydraulic tank.
4. Screw the plastic cap back onto the hydraulic oil filter compartment. Hand tighten.

Contact the manufacturer's recommended service provider to order a new hydraulic oil filter.

Always dispose of used oil filters in compliance with your local regulations.

INSPECT TRAILER BRAKES

- Visually inspect all brake pads for wear.
- If brakes aren't working properly, confirm the fuse is working and check the brake fluid level.

INSPECT PARKING BRAKE

- Visually inspect the parking brake handle for wear.
- If it's loose, turn the handle clockwise until it's tight.

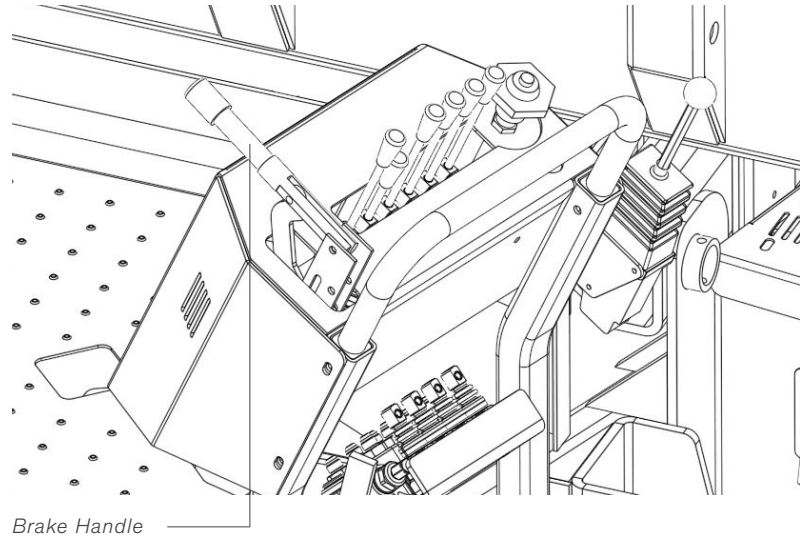

INSPECT BREAKAWAY SYSTEM

- Pull out the breakaway pin and listen for the actuator to make a humming noise from behind the engine area.
- If you don't hear the humming noise, check the inline fuse in the battery box. If needed, replace with a 30-amp fuse (not included in this 6-month service kit).

CHECK HYDRAULIC HOSES

- Visually inspect to ensure there's no dry rot, wear, or damage that exposes the wires beneath.
- Damaged hoses should be replaced immediately by a qualified service shop.

TIRES

- **Front tires:** visually inspect, check pressure, and, if needed, tighten lug nuts.
- **Rear tires:** visually inspect and check pressure. You must also make sure rear tire lug nuts are tightened to 140 ft-lbs, in the order outlined in the illustration.

Wheel bolt tightening sequence

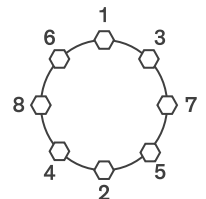

LUBRICATE FITTINGS

NOTE: Never work under the raised dump box without using the support arm to prevent the box from falling down.

To put the support arm in place, raise the dump bed, lift the support arm, and lower the dump box until it is resting on the support arm.

All four stabilizers and rollback must be fully extended when greasing fittings on the RB4000.

Greasing guidelines vary slightly on pre-2014 RB4000 units. For older units, contact the manufacturer's recommended service provider (Index A) for guidance on grease locations.

Use provided grease tube to apply lubricant to the following areas on all units:

Slide Rails

NOTE: Use provided gloves to apply the grease to slide rails directly.

1. With the rollback fully extended, grease the 3" x 5" tubes.
2. Grease the inside of the 4" x 6" tubes.

Wheel Lock Pin

NOTE: This step is applicable for units manufactured on or before October 2019. Units after October 2019 are equipped with a greaseless bushing.

1. Reach under the wheel lock guard.
2. Insert grease into the zerk.
3. Pull the wheel lock handle and grease the pin.

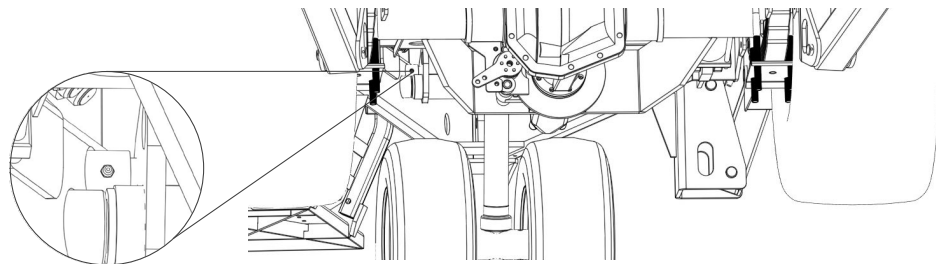
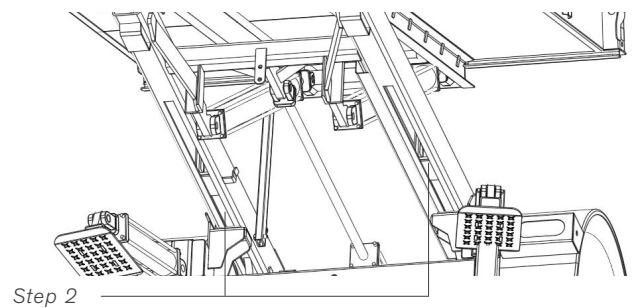
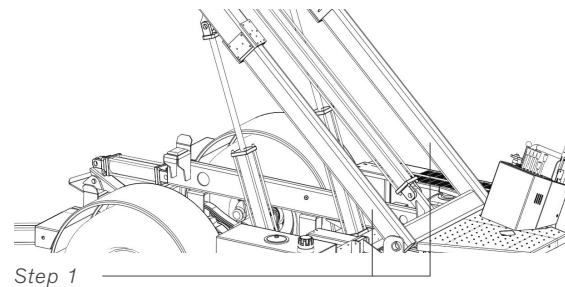
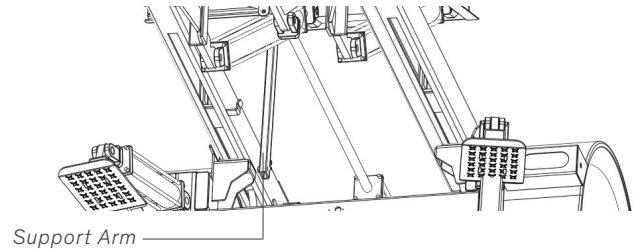

Wheel Lock Handle

1. Disengage the wheel lock pin.
2. Grease the wheel lock pin.
3. Replace the wheel lock pin.

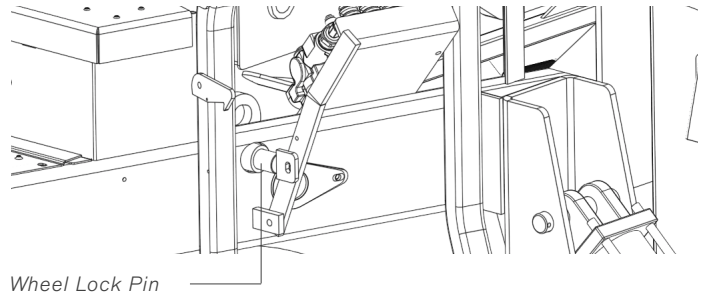

Wheel Lock Pin

Front Axle Hub

1. Use a flat screwdriver to remove the rubber grease cap.
2. Insert grease into the zerk until the zerk is full.
3. Spin the tire to ensure the wheel turns freely.
4. Replace the rubber grease cap.
5. Repeat on the opposite front wheel.

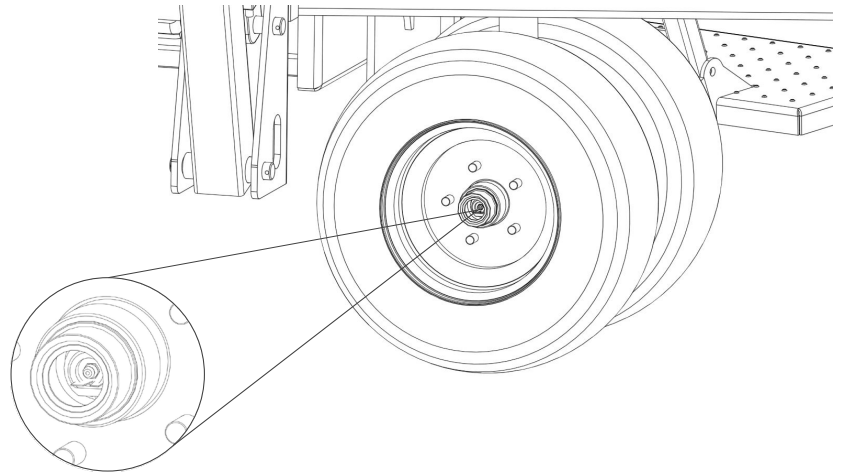

Axle Engagement System

NOTE: The fitting in the drive system should be lubricated every 40 hours to ensure proper operation. To access the grease fitting:

1. Engage the parking brake.
2. Lower the stabilizers.
3. Release the safety latch and raise the front steering wheels completely.
4. Tilt the dump box to gain access to the top of the drive axle. Place support arm under the dump box for additional safety while lubricating the axle engagement system. Ensure that the dump box is lowered until it rests securely on the support arm.
5. Insert grease into the zerk.

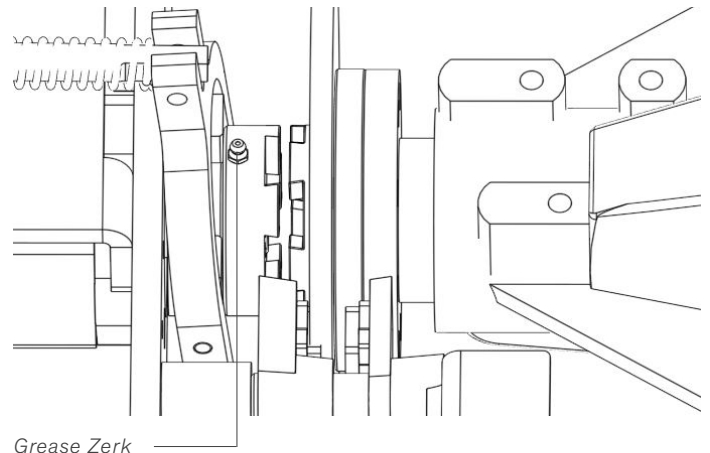

Grease Zerk

NOTE: If the grease fitting is rotated away and cannot be accessed, the drive system can be operated to spin the drive shaft. Use the drive control lever to “bump” the system until the grease fitting is accessible.

For additional replacement parts or service assistance, contact the manufacturer's recommended service provider.

INDEX A: SERVICE PROVIDERS

Manufacturer's Recommended Service Provider

Equipter, LLC
49 Eagle Drive
Suite 102
Leola, PA 17540

(717) 661-3591
support@equipter.com

Your Local Service Providers

Name: _____

Address: _____

Phone: _____

Email: _____

Notes: _____

Name: _____

Address: _____

Phone: _____

Email: _____

Notes: _____

INDEX B: SERVICE CHECKLIST

	Monthly	Every 6 Months	Annually	Every 3 Years
Torque Rear Lug Nuts	●	●	●	●
Check Breakaway System	●	●	●	●
Check Hydraulic Hoses	●	●	●	●
Check/Adjust Tire Pressure/Condition	●	●	●	●
Check Trailer Lights	●	●	●	●
Grease/Inspect Engagement	●	●	●	●
Check/Adjust Park Brake System	●	●	●	●
Change Air Filter		●	●	●
Change Engine Oil		●	●	●
Change Spark Plug		●	●	●
Grease Front Axle Lock Pin		●	●	●
Grease Dump Pivots (Pre-2014 Units Only)		●	●	●
Grease Centering Device (Pre-2013 Units Only)		●	●	●
Grease Rollers (Pre-2012 Units Only)		●	●	●
Grease Lift Pivots (Pre-2014 Units Only)		●	●	●
Grease Front Axle Zerks		●	●	●
Grease Slide Rails		●	●	●
Check Axle Oil		●	●	●
Check/Adjust Centering Device		●	●	●
Check Trailer Brakes		●	●	●
Check Hydraulic Oil Level		●	●	●
Check Brake Fluid		●	●	●
Check State Inspection (If Applicable)			●	●
Change Hydraulic Oil Filter				●
Change Hydraulic Oil				●
Change Axle Oil				●

INDEX C: RB4000 SERVICE SCHEDULE

Date: _____ Service Type: _____ Engine Hours: _____

Notes: _____

Date: _____ Service Type: _____ Engine Hours: _____

Notes: _____

Date: _____ Service Type: _____ Engine Hours: _____

Notes: _____

Date: _____ Service Type: _____ Engine Hours: _____

Notes: _____

Date: _____ Service Type: _____ Engine Hours: _____

Notes: _____

Date: _____ Service Type: _____ Engine Hours: _____

Notes: _____

INDEX C: RB4000 SERVICE SCHEDULE

Date: _____ Service Type: _____ Engine Hours: _____

Notes: _____

Date: _____ Service Type: _____ Engine Hours: _____

Notes: _____

Date: _____ Service Type: _____ Engine Hours: _____

Notes: _____

Date: _____ Service Type: _____ Engine Hours: _____

Notes: _____

Date: _____ Service Type: _____ Engine Hours: _____

Notes: _____

Date: _____ Service Type: _____ Engine Hours: _____

Notes: _____
